

# INDUSTRIAL AREA AND ESTATE BUXAR

Total Area- 50.22 Acre

N

Vacant Plot-

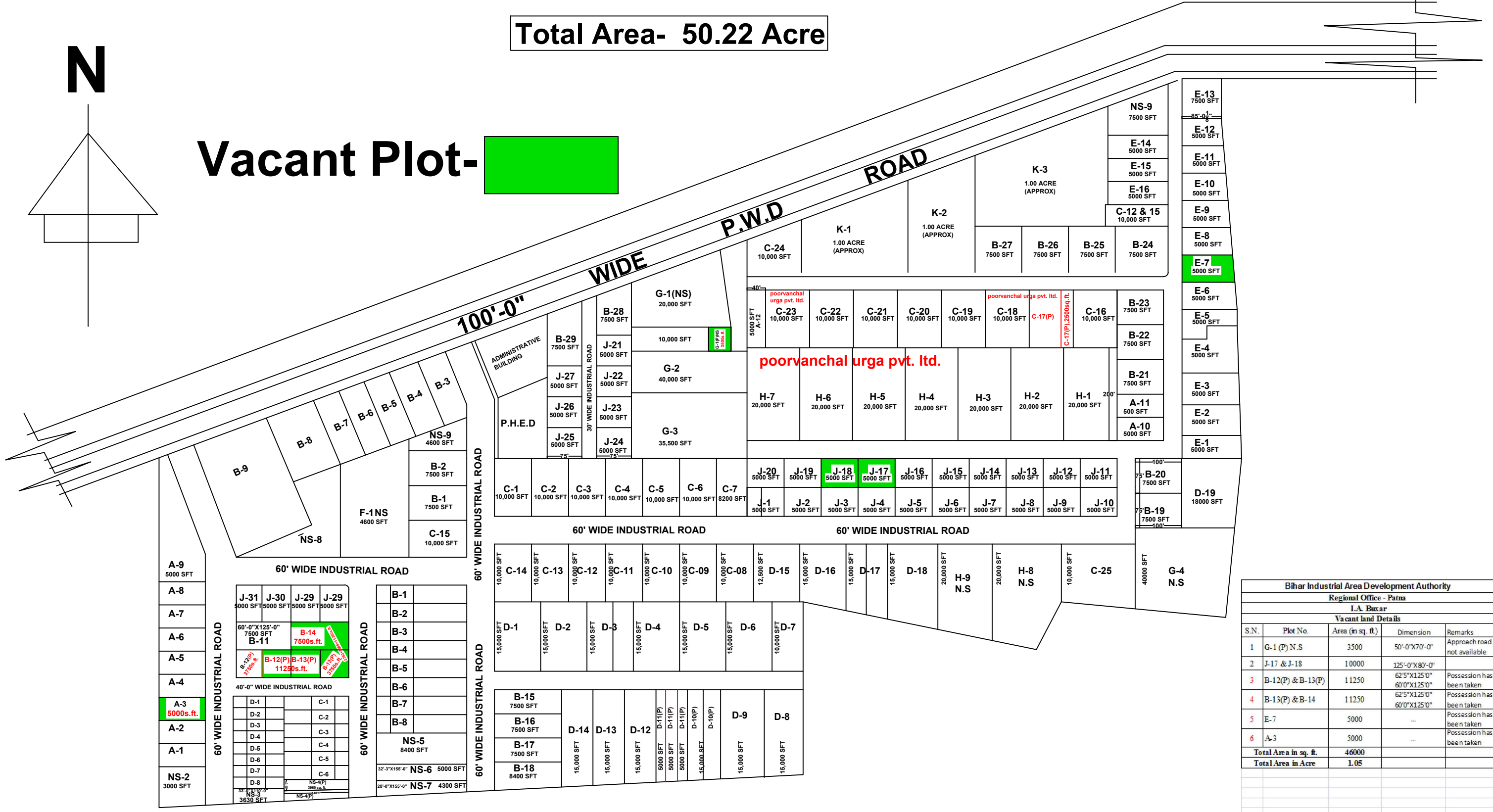

Bihar Industrial Area Development Authority				
Regional Office - Patna				
I.A. Buxar				
Vacant land Details				
S.N.	Plot No.	Area (in sq. ft.)	Dimension	Remarks
1	G-1 (P) N.S	3500	50'-0"X70'-0"	Approach road not available.
2	J-17 & J-18	10000	125'-0"X80'-0"	
3	B-12(P) & B-13(P)	11250	62'5"X125'0" 60'0"X125'0"	Possession has been taken
4	B-13(P) & B-14	11250	62'5"X125'0" 60'0"X125'0"	Possession has been taken
5	E-7	5000	---	Possession has been taken
6	A-3	5000	---	Possession has been taken
Total Area in sq. ft.		46000		
Total Area in Acre		1.05		

<b>Amin</b> BIADA, Patna	<b>Area-In-Charge</b> I.A/I.E. Buxar	<b>Development officer</b> BIADA, Patna	<b>Draftsman</b> BIADA