

INDUSTRIAL ESTATE KATIHAR

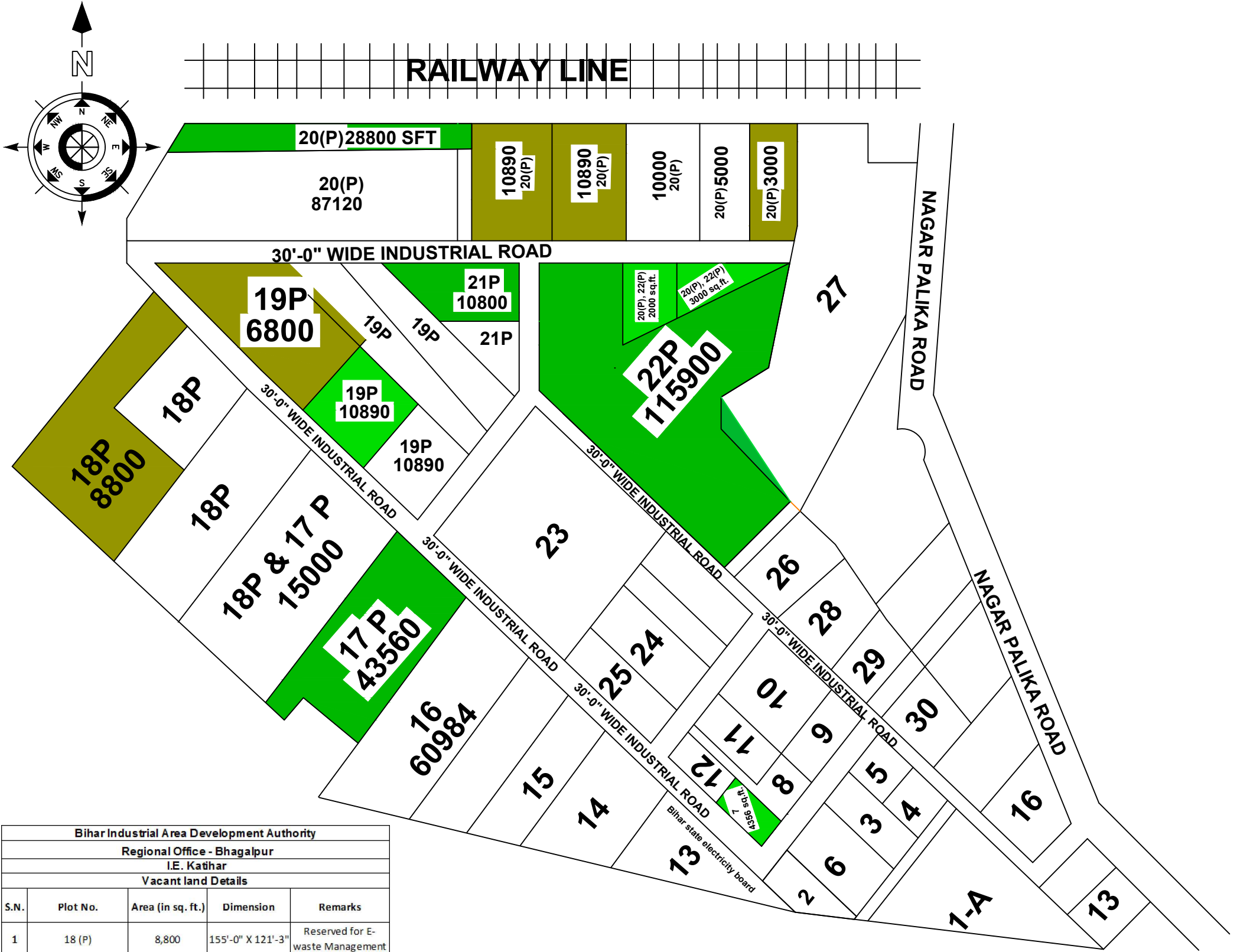



Total Area- 24.31 Acre

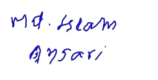

Bihar Industrial Area Development Authority				
Regional Office - Bhagalpur				
I.E. Katihar				
Vacant land Details				
S.N.	Plot No.	Area (in sq. ft.)	Dimension	Remarks
1	18 (P)	8,800	155'-0" X 121'-3"	Reserved for E-waste Management
2	19 (P)	6,800	137'-0" X 50'-0"	Reserved for E-waste Management
3	19 (P)	10,890	160'-0" X 68'-0"	
4	20 (P)	28,800	64'-0" X 45'-0"	
5	21 (P)	10,800	135'-0" X 80'-0"	
6	22 (P)	115,900	386'-0" X 300'-0"	
7	20(P)	10,890	135'0"x80.67'0"	Reserved for E-waste Management
8	20(P)	10,890	135'0"x80.67'0"	Reserved for E-waste Management
9	20(P)	3,000.00	135'0"x22.22'0"	Reserved for E-waste Management
10	7	4,356.00	100'0"x43.56'0"	
11	20-(P), 22-(P)	2,000.00	80'0"x25'0"	
12	20-(P), 22-(P)	3,000.00	100'0"x30'0"	
13	17(P)	43,560.00	...	
Total Area in sq. ft.		259,686.00		
Total Area in Acre		5.96		

Vacant Land -

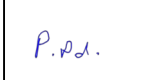
Reserve for Waste Processing Unit -

				
Amin BIADA, Bhagalpur	Area-In-Charge I.E. Katihar	Asstt. Development officer BIADA, Bhagalpur	Development officer BIADA, Bhagalpur	Draftsman BIADA